

The Max-Air greenhouse has the same structure as found in the traditional Venlo greenhouse but with a newly designed roof system.

The roof of the Max-Air provides full ventilation when opened, but still offers superior protection from the elements when closed. The roof hinges at the gutter and seals at the roof ridge.

This design is eminently suitable for growers with crops such as bedding plants or nursery stock where hardening off of the crop is required.

For those plants that like the outdoors but need the protection of a greenhouse from time to time, the Max-Air Greenhouse is the ideal solution.

Two options are available for the ventilation system: Rack & pinions or the push/pull bars.

When rack & pinions are used both sides open simultaneously. The drive shaft is mounted in the peak where the pinion housing is attached.

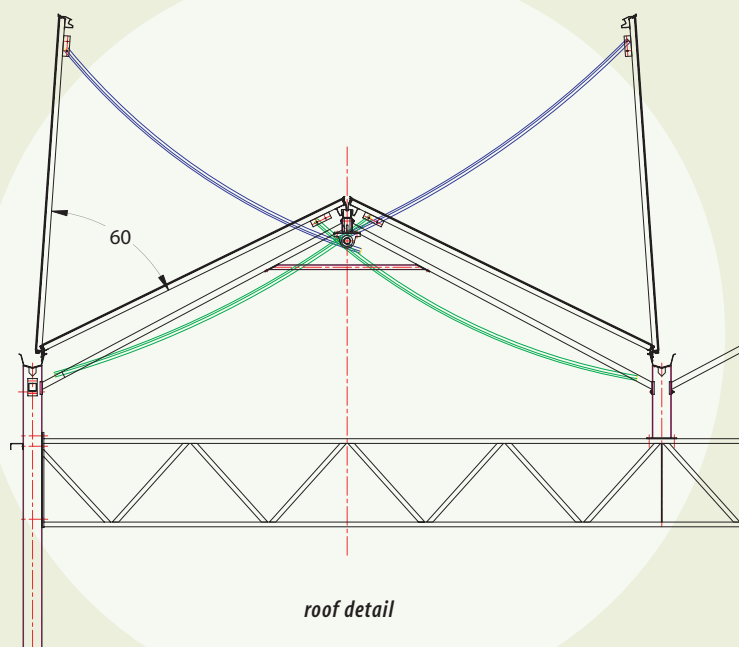
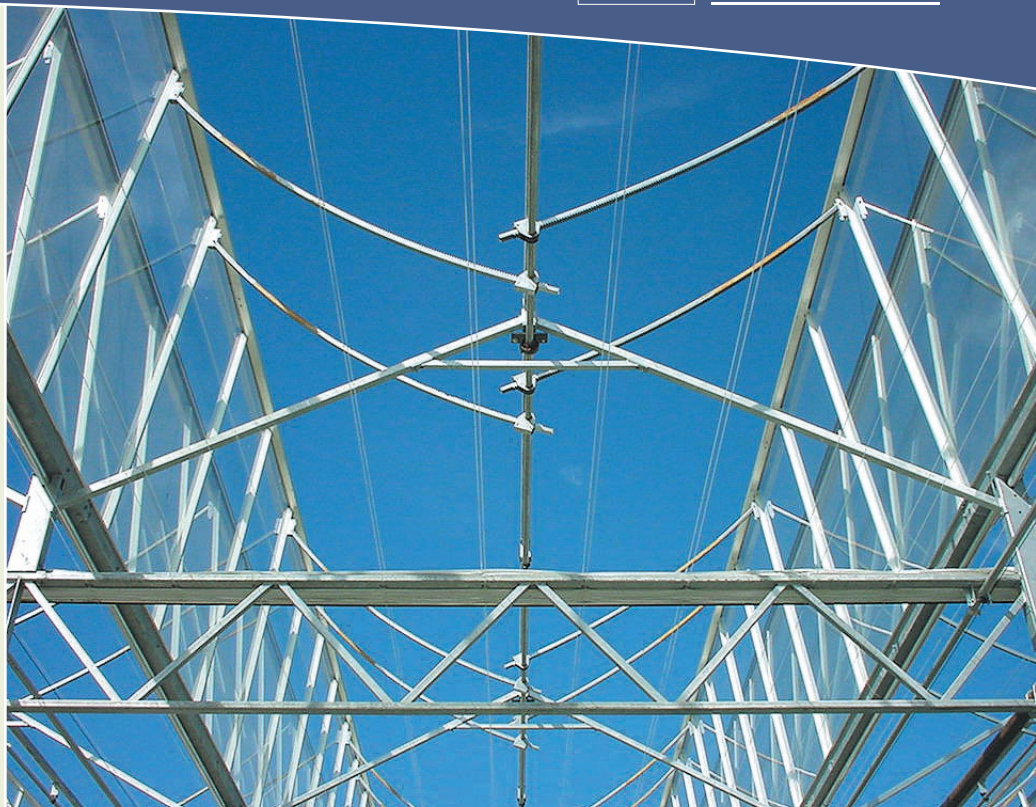

see over >

MAX-AIR GREENHOUSES



When the system with push/pull bars are used both sides are opened independently. This can be an advantage to keep wind and rain out of the greenhouse and ventilate at the same time. For this model, the truss is mounted lower to allow for a curtain system which connects to the top cord of the truss.

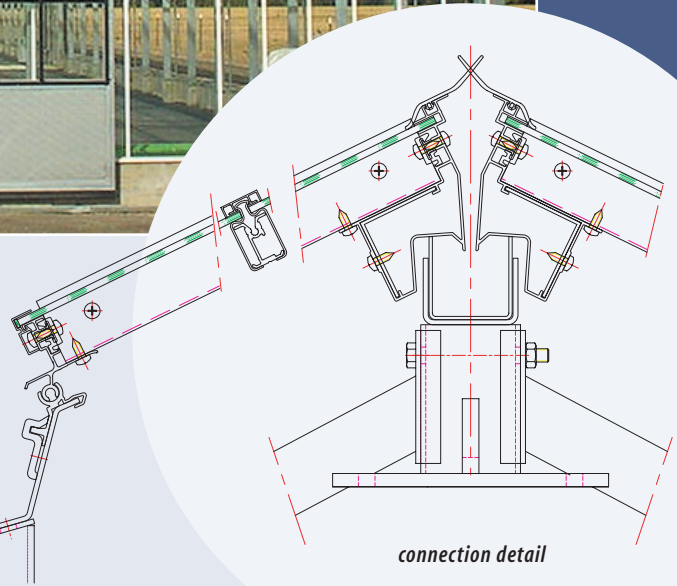
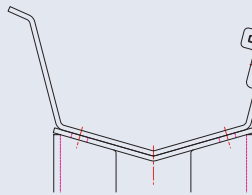

With these options, we can provide you with the best Max-Air greenhouse for your application.



PRINS
Greenhouses

Construction • Systems • Supplies

3890 No. 4 Road
Abbotsford, British Columbia
Canada V3G 2G2
Tel: 604.852.4001 Fax: 604.852.4090
E-mail: admin@prinscanada.com